

Model : ATZ FO-SFP-MMDP0.5K-LC-D

Description: SFP Transceiver 1.25G/850nm Dual fiber/MM/550M/LC/DDMI/Cisco Compatible



The HD-S8512-1LCD IS small form factor pluggable (SFP) transceiver compatible with multi-sourcing agreement (MSA). It is suitable for single-mode fiber (SMF) communications in 1.25Gbps Ethernet and 1G/2G Fiber Channel.

Regulatory Compliance

ATZ transceivers are Class 1 Laser Products comply with FDA regulations. Meet Class 1 eye safety requirements of EN 60825 and the electrical safety requirements of EN 60950.

Model : ATZ FO-SFP-MMDP0.5K-LC-D

Description: SFP Transceiver 1.25G/850nm Dual fiber/MM/550M/LC/DDMI/Cisco Compatible

Features:

- Up to 1.25Gbps data links
- 550m with 50/125µm MMF
- 270m with 62.5/125µm MMF
- 850nm VCSEL laser
- Duplex LC Connector
- Hot-pluggable SFP footprint
- Single 3.3V power supply
- Operating temperature: Ref.to ordering info
- RoHS
- Digital Diagnostic Monitor (DDM)*

Applications

- √ 1.25Gbps 1000Base-LX
- √ 1G/2G Fiber Channel

Specifications:

Absolute Maximum Ratings

Parameter	Symbol	Min.	Max.	Unit
Supply Voltage	VCC	-0.5	3.6	V
Storage Temperature	TS	-40	85	°C
Operating Case Temperature	TC	Refer to ordering information		

Recommended Operating Conditions

Parameter	Symbol	Min.	Typical	Max.	Unit
Operating Case Temperature	TC	Refer to ordering information			
Power Supply Voltage	VCC	3.15	3.3	3.45	V
Power Supply Current	ICC			250	mA
Data Rate			1.25		GBps
Max Link Length on	Lmax			20	km

Model : ATZ FO-SFP-MMDP0.5K-LC-D

Description: SFP Transceiver 1.25G/850nm Dual fiber/MM/550M/LC/DDMI/Cisco Compatible

9/125µm SMF					
-------------	--	--	--	--	--

Optical Characteristics

Parameter	Symbol	Min.	Typical	Max.	Unit
Transmitter					
Centre Wavelength	λ_c	840	850	860	nm
Spectral Width (RMS)	σ			3	nm
Average Output Power	Pout	-9		-3	dBm
Extinction Ratio	EX	9			dB
Optical Rise/Fall Time	tr/tf			1	ns
Receiver					
Centre Wavelength	λ_c	840	850	860	nm
Receiver Sensitivity	PIN			-18	dBm
Receiver Overload	Pmax	1			dBm
LOS De-Assert	LOSD			-24	dBm
LOS Assert	LOSA	-35			dBm
LOS Hysteresis		0.5		4.5	dB

Electrical Characteristics

Parameter	Symbol	Min.	Typical	Max.	Unit
Transmitter					
Input Differential Impedance	Zin	90	100	110	Ω
Data Input Swing Differential	Vin	500		2400	mV
Tx-Dis Disable	Vd	2.0		Vcc	V
Tx-Dis Enable	Ven	0		0.8	V
TX-Fault (Fault)		2.0		Vcc+0.3	V
TX-Fault (Normal)		0		0.8	V
Receiver					
Data Output Swing Differential	Vout	370		2000	mV
Rx-Los Fault	Vlf	2.0		Vcc+0.3	V

Model : ATZ FO-SFP-MMDP0.5K-LC-D

Description: SFP Transceiver 1.25G/850nm Dual fiber/MM/550M/LC/DDMI/Cisco Compatible

Rx-Los Normal	VIn	0	0+0.8	V
---------------	-----	---	-------	---

Pin Descriptions

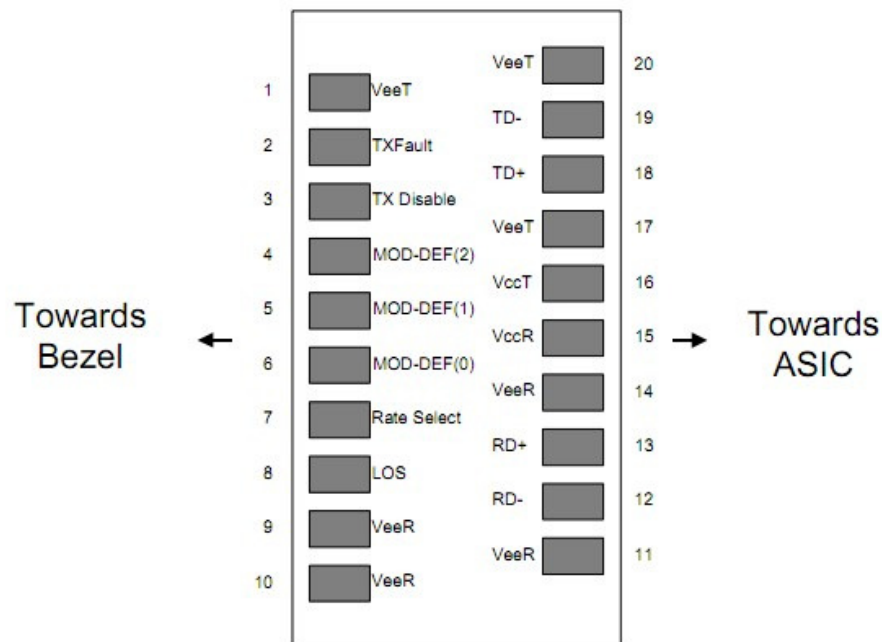

Diagram of Host Board Connector Block Pin Numbers and Names

Pin	Symbol	Description	Ref.
1	VEET	Transmitter Ground (Common with Receiver Ground)	6.1
2	TFAULT	Transmitter Fault. Not supported.	
3	TDIS	Transmitter Disable. Laser output disabled on high or open.	6.2
4	MOD_DEF(2)	Module Definition 2. Data line for Serial ID.	6.3
5	MOD_DEF(1)	Module Definition 1. Clock line for Serial ID.	6.3
6	MOD_DEF(0)	Module Definition 0. Grounded within the module.	6.3
7	Rate Select	No connection required	
8	LOS	Loss of Signal indication. Logic 0 indicates normal operation.	6.4
9	VEER	Receiver Ground (Common with Transmitter Ground)	6.1
10	VEER	Receiver Ground (Common with Transmitter Ground)	6.1
11	VEER	Receiver Ground (Common with Transmitter Ground)	6.1
12	RD-	Receiver Inverted DATA out. AC Coupled.	
13	RD+	Receiver Non-inverted DATA out. AC Coupled.	
14	VEER	Receiver Ground (Common with Transmitter Ground)	6.1
15	VCCR	Receiver Power Supply	

Model : ATZ FO-SFP-MMDP0.5K-LC-D

Description: SFP Transceiver 1.25G/850nm Dual fiber/MM/550M/LC/DDMI/Cisco Compatible

16	VCCT	Transmitter Power Supply	
17	VEET	Transmitter Ground (Common with Receiver Ground)	6.1
18	TD+	Transmitter Non-Inverted DATA in. AC Coupled.	
19	TD-	Transmitter Inverted DATA in. AC Coupled.	
20	VEET	Transmitter Ground (Common with Receiver Ground)	6.1

Notes:

- 6.1 Circuit ground is internally isolated from chassis ground.
- 6.2 Laser output disabled on TDIS >2.0V or open, enabled on TDIS <0.8V.
- 6.3 Should be pulled up with 4.7k - 10kohms on host board to a voltage between 2.0V and 3.6V. MOD_DEF(0) pulls line low to indicate module is plugged in.
- 6.4 LOS is open collector output. Should be pulled up with 4.7k -10kohms on host board to a voltage between 2.0V and 3.6V. Logic 0 indicates normal operation; logic 1 indicates loss of signal.

EEPROM & DDM THRESHOLD

EEPROM

2 wire address 1010000X (A0h)

0~95	Serial ID Defined by SFP MSA (96 bytes)
96~127	Vendor Specific (32 bytes)
128~255	Reserved (128 bytes)

EEPROM Serial ID Memory Contents

Add.	Size (Bytes)	Name of Field	Hex	Description
BASE ID FIELDS				
0	1	Identifier	03	SFP
1	1	Ext. Identifier	04	SFP function is defined by serial ID only
2	1	Connector	07	LC
3-10	8	Transceiver	00 00 00 02 00 00 00 00	Transmitter Code
11	1	Encoding	01	8B/10B
12	1	BR, Nominal	0D	1.25Gbps

Model : ATZ FO-SFP-MMDP0.5K-LC-D

Description: SFP Transceiver 1.25G/850nm Dual fiber/MM/550M/LC/DDMI/Cisco Compatible

13	1	Reserved	00	
14	1	Length (9um) km	00	550m 270m
15	1	Length (9um) km	00	
16	1	OM2 Length (50um) m	37	
17	1	OM1 Length (62.5um) m	1B	
18	1	Length (Copper)	00	
19	1	OM3 Length (50um) m	00	
20-35	16	Vendor Name	48 41 4E 44 41 52 20 20 20 20 20 20 20 20 20 20	HANDAR * OEM available
36	1	Reserved	00	
37-39	3	Vendor OUI	00 00 00	* OEM available
40-55	16	Vendor PN	xx xx xx xx xx xx xx xx xx xx xx xx xx xx xx xx	* OEM available
56-59	4	Vendor Rev	30 31 20 20	01
60-61	2	Wavelength	05 IE	1310nm
62	1	Reserved	00	
63	1	CC_BASE	xx	Check Code for Base ID Field
EXTENDED ID FIELDS				
64-65	2	Options	00 1A	Loss/ TX_Fault/ TX_Disable
66	1	BR, Max	00	
67	1	BR, Min	00	
68-83	16	Vendor SN	43 4C xx xx xx xx xx xx xx xx xx 20 20 20 20 20	SN of Transceiver (ASCII). Exp. "HDXXXXXXXXXX"
84-91	8	Date Code	xx xx xx xx xx xx 20 20	YY/MM/DD Exp. 120727
92	1	Diagnostic Monitoring	68	
93	1	Enhanced Options	90	
94	1	SFF_8472 Compliance	01	
95	1	CC_EXT	checksum	Checksum for Extended ID
VENDOR SPECIFIC ID FIELDS				
96-127	32	Vendor Specific	20 20 20.....	Depends on Customer Info
128-255	128	Reserved	FF FF FF.....	Depends on Customer Info

Model : ATZ FO-SFP-MMDP0.5K-LC-D

Description: SFP Transceiver 1.25G/850nm Dual fiber/MM/550M/LC/DDMI/Cisco Compatible

DDM THRESHOLD

		Low Alarm	Low Warn	High Warn	High Alarm
Temperature	HD-S8512-1LCD -I	-45°C	-40°C	85°C	90°C
	HD-S8512-1LCD	-10°C	0°C	70°C	75°C
Voltage		3V	3.1V	3.5V	3.6V
Tx Bias		15mA	20mA	40mA	45mA
Tx Power		-13.5dBm	-9.5dBm	-1dBm	1dBm
Rx Power		-23dBm	-19dBm	-3dBm	1dBm

Recommend Circuit

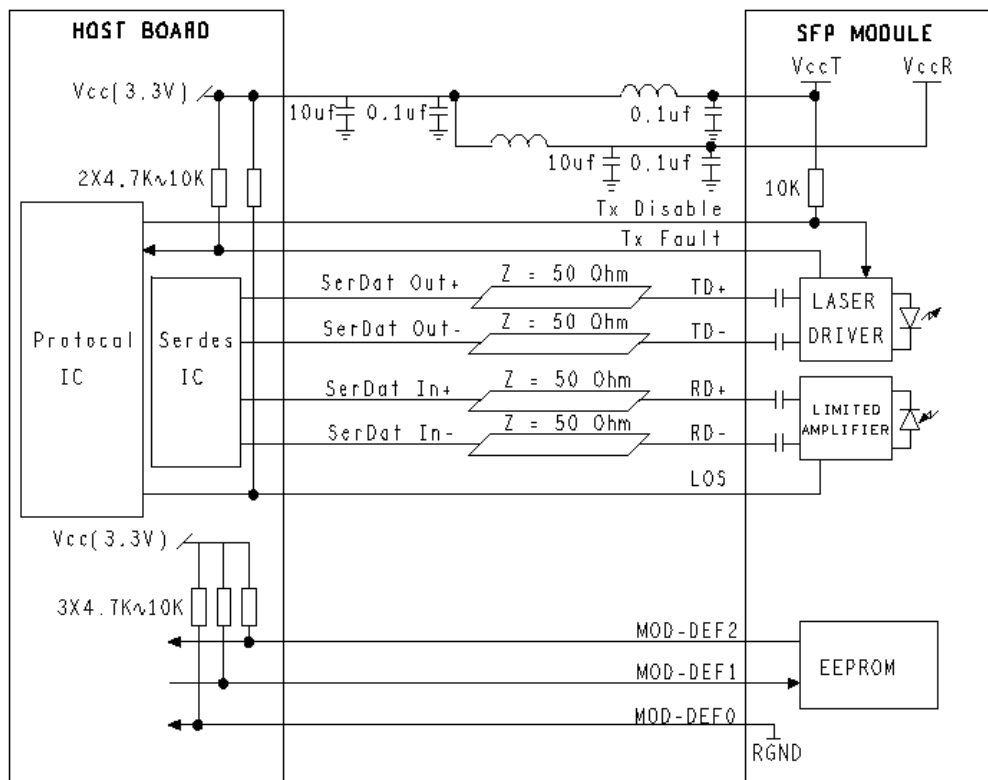

Model : ATZ FO-SFP-MMDP0.5K-LC-D

Description: SFP Transceiver 1.25G/850nm Dual fiber/MM/550M/LC/DDMI/Cisco Compatible

Package Includes:

1x SFP Transceiver

Product Diagram:

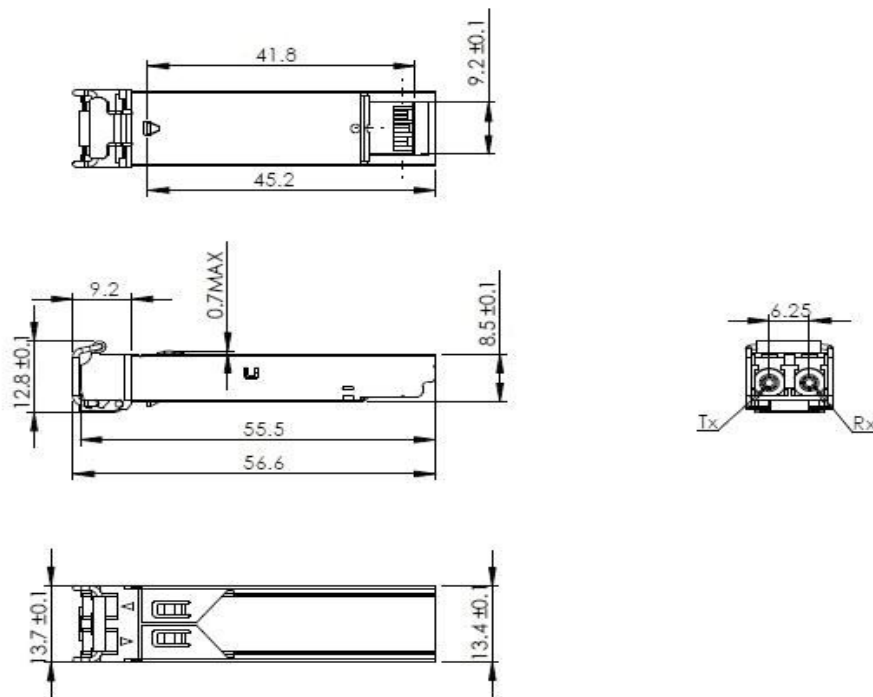

Warranty: 3 Years

Warranty is effective from the date of original delivery.

This warranty shall be void if a serial number has been removed from the product.